

Scale 1:500

This map is reproduced from Ordnance Survey material with the permission of Ordnance Survey on behalf of the Controller of Her Majesty's Stationery Office © Crown copyright. Unauthorised reproduction infringes Crown copyright and may lead to prosecution or civil proceedings.  
 Dover District Council Licence No. LA0778X published 2002.

**GROUND FLOOR**

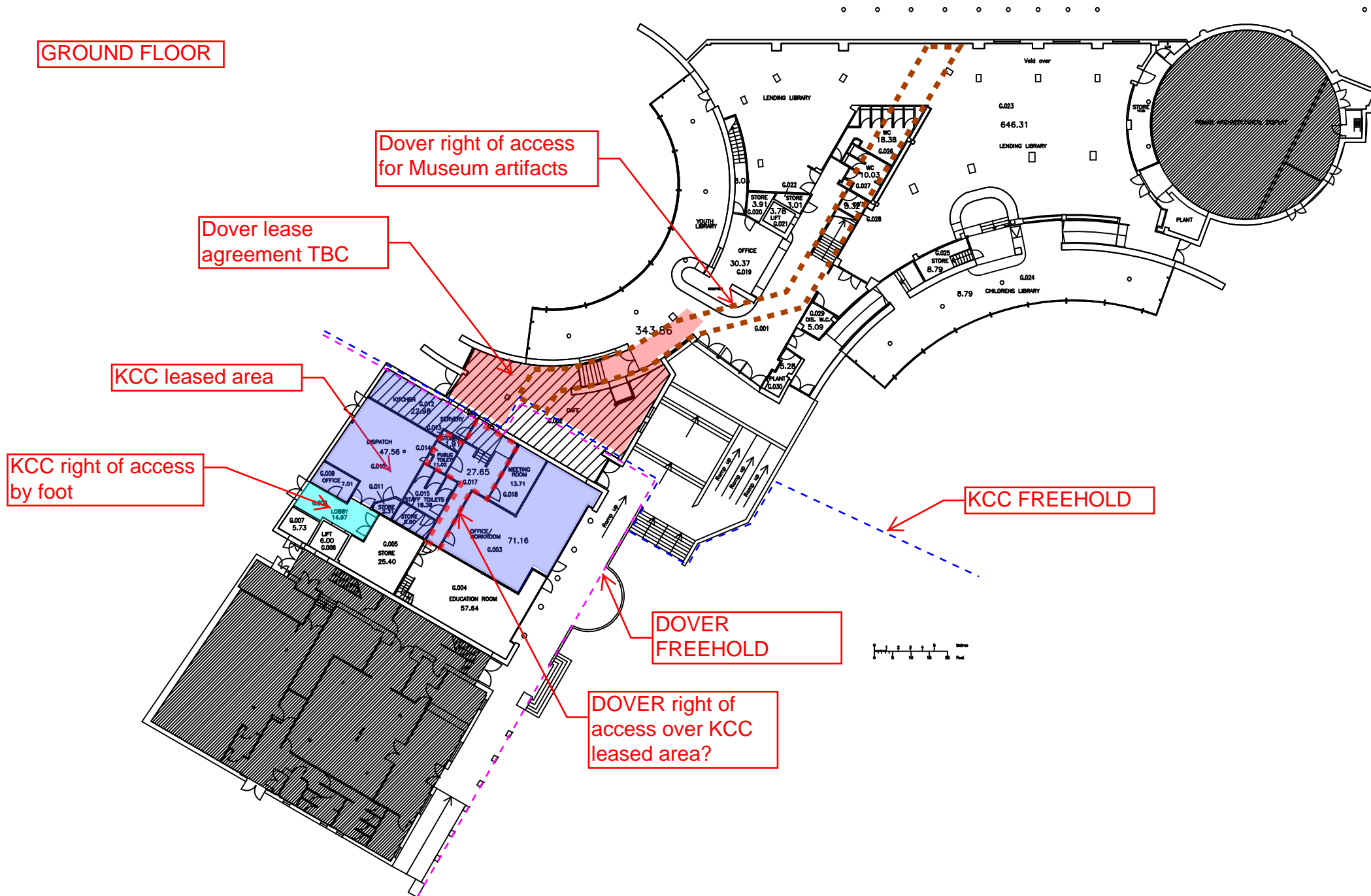

**Dover right of access for Museum artifacts**

**Dover lease agreement TBC**

**KCC leased area**

**KCC right of access by foot**

**KCC FREEHOLD**

**DOVER FREEHOLD**

**DOVER right of access over KCC leased area?**

GROSS EXTERNAL FLOOR AREA = 1838.700 m<sup>2</sup>  
 GROSS INTERNAL FLOOR AREA = 1754.554 m<sup>2</sup>  
 NET INTERNAL FLOOR AREA = ? m<sup>2</sup>

No	Revision description	Date	Checked
----	----------------------	------	---------

This plan originated from Kent County Council. Further information regarding this plan can be obtained from Glyn Parham at Kent County Council Telephone: 01622 686340  
 This plan was surveyed by AGP and digitized at a scale of 1:100

No	Revision description	Date	Checked
----	----------------------	------	---------

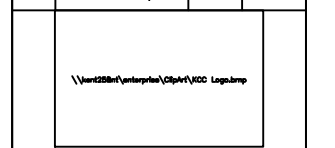

**PROPERTY GROUP**  
 County Hall  
 Maidstone  
 Kent ME14 1JQ  
 Tel (01822)971411

BRANCH

PROJECT REF

PROJECT  
**DOVER DISCOVERY CENTRE**

DRAWING TITLE  
**GROUND FLOOR PLAN**

00040100

SCALE **1:200**

DRAWN BY <b>AGP</b>	CHECKED	DATE <b>JUL 05</b>
------------------------	---------	-----------------------

DRAWING No <b>DV-F03IG</b>	REV No
-------------------------------	--------



FIRST FLOOR

Dover right of access for Museum artifacts

DOVER LEASED AREA DEMISE

FREEHOLD BOUNDARY

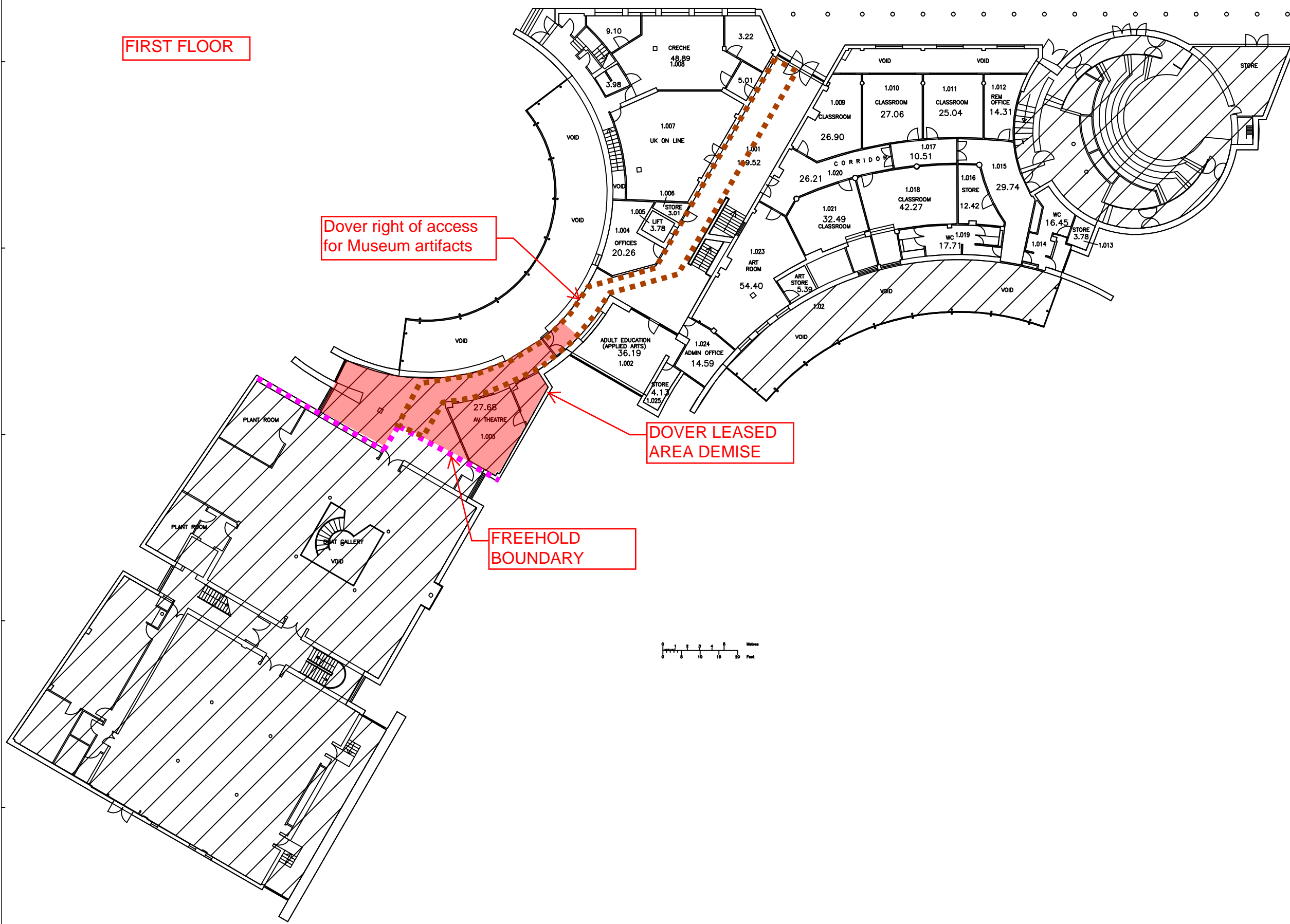

GROSS EXTERNAL FLOOR AREA = 2400.980 m<sup>2</sup>  
 GROSS INTERNAL FLOOR AREA = 2282.150 m<sup>2</sup>  
 NET INTERNAL FLOOR AREA = ? m<sup>2</sup>

No	Revision description	Date	Checked
----	----------------------	------	---------

This plan originated from Kent County Council. Further information regarding this plan can be obtained from Glyn Park at Kent County Council Telephone: 01622 696340

This plan was surveyed by AGP and digitized at a scale of 1:100

No	Revision description	Date	Checked
----	----------------------	------	---------

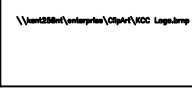

PROPERTY GROUP  
 County Hall  
 Maidstone  
 Kent ME14 1XQ  
 Tel (01622)714111

BRANCH

PROJECT REF

PROJECT  
 DOVER DISCOVERY CENTRE

DRAWING TITLE  
 FIRST FLOOR PLAN

00040100

SCALE 1:100

DRAWN BY AGP	CHECKED	DATE JUL 05
-----------------	---------	----------------

DRAWING No DV-F0311	REV No
------------------------	--------